

With the removal of construction hoardings in recent weeks it is now possible for us all to see the impressive scale and exterior aesthetics of our new primary school. This first newsletter, edited by the Parents' Association, aims to provide a summary update on the new school. Specifically, it will provide a high-level description of the school and explain the proposed traffic management system for school pupil drop-offs and collections. We hope that you will find the newsletter both interesting and informative.

High-level overview of the school:

The school, located on the main approach road into Kill Village off the N7 dual carriageway, will have 32 self-contained classrooms (including toilets, computer points, etc.) and a Special Needs unit. The site covers an area of approximately 5.15 acres (2.08 Hectares). It is an elevated site which rises steeply from the northwest boundary along its primary road frontage, to the rear of the site (southeast) bounded by a country lane, with an overall level difference of approximately 9.8 metres. The road frontage itself, falls a total of 6.5 metres along its length on the approach into the village.

Overleaf is an illustration of the school development.

The building is set at an angle to follow the natural contours of the site. A turning circle and set-down for buses and cars is provided inside the site entrance leading up to the front doors of the main building and Special Needs unit. Staff and visitor car parking is located to the west of the site with the adjoining 4 x hard-play courts doubling as a drop-off / collection area for parents.

Two of the 4 x hard-play courts will be lined for basketball. A junior hard-play area is provided to the rear of the building adjoining a large grass area.

From a landscaping perspective most significant trees are retained; each external space will have new planting and paving; and the boundary of the site and the boundary between vehicular and pedestrian areas will be reinforced with planting.

The irregular form and the planning of the building, with the changes of scale and the variety of spatial incident, colour and texture, are all intended to stimulate the pupils over the eight years of primary education and create a sense of place and delight for the staff and pupils.

The building is part two-storey and part three-storey. The building is within a cranked linear plan, with the General Purpose (Gym) area forming a special feature central to the scheme.

Some key features of the school building are:

- central welcoming entrance with access to the General Purpose area and all teaching spaces;
- multiple access / egress points at mid point and ends of the building;
- principal's office and administration office centrally located to facilitate supervision and control;
- the library is located centrally on the 1st floor level;
- the staff room is located on the 1st floor, along with staff toilets and shower facilities; and
- design intent is to minimise the use of energy in lighting and heating the school.

Play Areas:

The school will have 5 separate play areas to accommodate the needs of children of all ages. These areas are:

- 4 x hard-play courts to the west of the new building (doubling as a drop-off / collection point);
- Senior hard-play area to the front of new building;
- Junior soft-play area to the rear of the school;
- Special Needs Unit soft-play area to the east of the school: and
- All-weather 30m x 40m astro-turf playing area marked out as 1 x Gaelic pitch lengthwise and 2 x soccer pitches across.

Traffic Management:

In the interests of safety to both road users and school pupils, there will not be a lay-by arrangement on the public roadway adjacent to the new school entrance for setting down. Instead, set-down areas for buses in addition to parking spaces for cars are provided within the confines of the site.

As described above, the bus turning circles / set-down facilities will be located immediately adjacent to the main site entrance, avoiding the necessity to take traffic deep into the site and potential conflict with pedestrians. The 4 x hard-play courts will double as set-down / collection point in the mornings and afternoons – this is designed for short term parking to allow parents leave children into the school and then exit without reversing.

Further Information:

To view progress of the construction of our new school log onto the school's website, www.killschool.ie, and click on the New School tab on the left side of the home page.

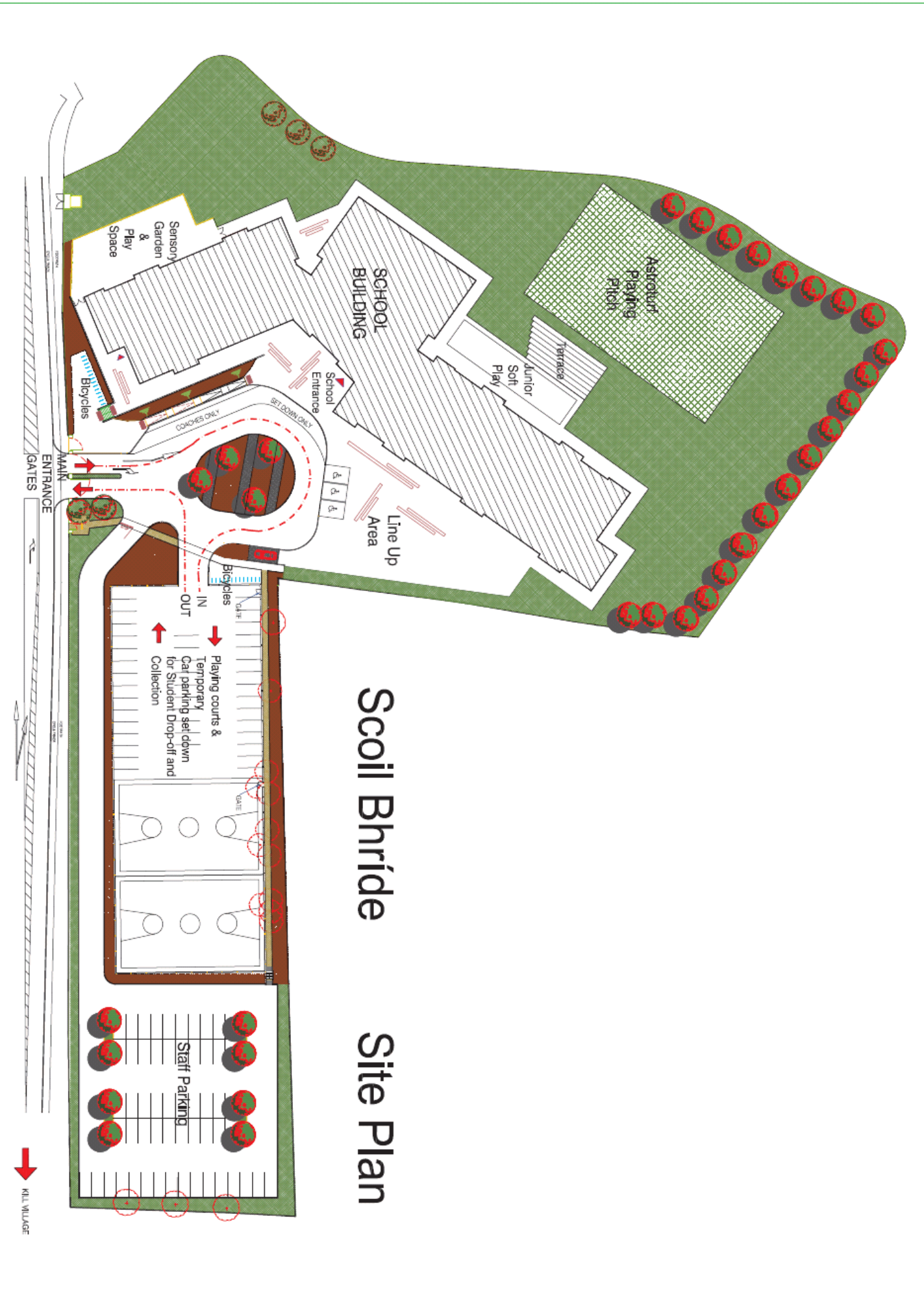

Scoil Bhríde

Site Plan

→ KILL VILLAGE